

I-shaped shower curtain rod, adjustable, BA90VC007

| | |
|---------------------|-----------------------------------|
| Serie | Duschvorhangstangen / -schienen |
| Typ | Duschvorhangschienen und -stangen |
| Material | chrome plated |
| Length cm | 170 |
| Richner-Nr. | 4454721 |
| Sanitas-Troesch Nr. | 1712 317 501 |
| Team Nr. | 171307 501 |

Produktbeschreibung

BODENSCHATZ shower curtain rod, 170 cm, diameter 2 cm, concealed fixing, chrome-plated brass, adjustable

Produktabbildung

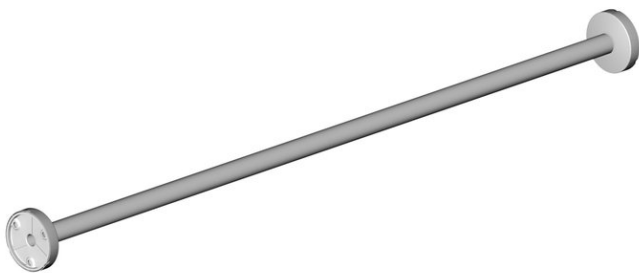

Masszeichnung

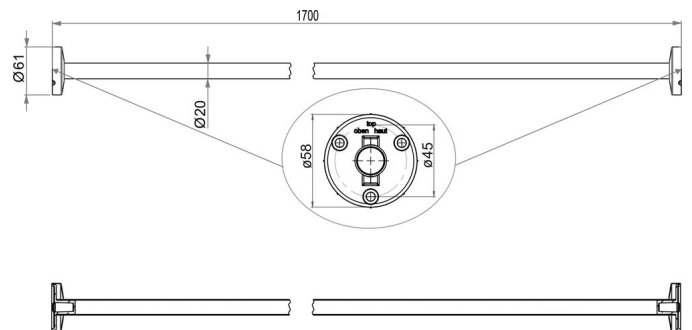

Pflegehinweise

Finden Sie unter [bodenschatz.ch/en-ch/service/reinigung-pflege/](https://www.bodenschatz.ch/en-ch/service/reinigung-pflege/)

Ersatzteile & Zubehör

| | |
|------------|--|
| BA40IN840 | Set of hex socket screws |
| BA81XX904 | Mounting set flat head screws for drilling |
| BA90VC036 | Ceiling support for shower curtain rods |
| BA90VC037 | Ceiling support for shower curtain rods |
| BA90WS053 | Curtain ring for shower curtain rod |
| BA93WS180K | Shower curtain |
| BA93WS180L | Shower curtain |